

# SC-201-A/PA Cross cut linear sampler

## Technical specifications

**Type:** Cross cut linear sampler

**Serie:** SC

- Our RUDO Samplers Model “SC-201”, designed under ISO and CNAM Standards, are linear sampler suitable for solids, slurries and concentrates.
- These samplers are usually used as primary samplers and are set in transference points such as discharge chutes and distribution boxes.
- According to the size of the process, they can be installed as unique sampling equipment or as part of a multistage system or sampling tower.
- The size of the drive varies according to the size of the conveyor or launder. Our available sizes are from 4” to 165”.



### Sample Cutter

We supply the equipments with sampler cutters and blades manufactured in T1 or Stainless Steel. The cutter type can be either bottom dump for solids or “D type” for slurries.

### Applied Engineering

RDI conducts the associated engineering according to our Customers’s special requirements, assuring performance and reliability under design conditions.



# SC-201-A/PA Cross cut linear sampler

## Technical specifications

**Type:** Cross cut linear sampler

**Serie:** SC



Equipment's information			
Type of material to be sampled	Bulk solids	Moist concentrates	Slurries
Description	Cross cut linear sampler for transference points in conveyor belts		Cross cut linear sampler for transference points in gravity flows
Operation	Linear cut in transference points such as head pulley chute		Linear cut in transference points such as distribution box
Main application	Size, chemical and water content analysis		
Sampling mode	Bottom type sample cutter with adjustable and replaceable parallel blades		D type cutter with adjustable and replaceable parallel blades
Mounting	Over head chute		Over distribution or discharge box
Linear cutter speed	Fixed or VFD controlled 0,45 m/s max speed		
Material of construction	Transmission	Structure and covers in ASTM A36 Mild Steel.	
	Cutter's body	ASTM A36 mild Steel	Either AISI 316L SAF 2205
	Cutter's blades	400 HBN Steel	Either AISI 316L SAF 2205
Drive	NEMA or IEC Electric geared motor		
Drive's protection	IP65	IP65	IP66
Transmission	Standard	Roller chain and sprockets	
	Optional	Pinion and rack	
Translation cart	SC-201-A Model	Simple cart with four wheels over one-rail guide	
	SC-201-PA Model	Double cart with eight wheels over two-rail guide	
Available sizes	SC-201-A Model	18" to 60" conveyors	Launders up to 1000 mm width
	SC-201-PA Model	24" to 72" conveyors	Launders up to 4500 mm width
Control supply	Standard	110V 1Ph 50/60 Hz	
	Optional	220V 1Ph, 50/60 Hz	
Power supply	Standard	380V 3Ph 50/60 Hz	
	Optional	460V-600V 3Ph 50/60 Hz	
Control system	Standard	Joint box fixed to chassis, position sensors, PLC in IP66 Cabinet, Programming	
	Optional	VFD, Beacon	
		4,3" LCD TFT Touch Screen	
Sampling frequency	Manual	With Jog	
	Automatic	Programmable sampling frequency	
Additional	Modbus or ProfiBus communication to DCS		
Typical configurations	As primary sampler in a multi-stage system	As primary and secondary samplers in a multi-stage system	As primary sampler in a multi-stage system

**Note:**

1\_ RDI S.A. reserves the right to modify models, components, specifications and models continuity at any momento, at any time without previous notification.



# SC-201-A/PA Cross cut linear sampler

## Technical specifications

**Type:** Cross cut linear sampler

**Serie:** SC

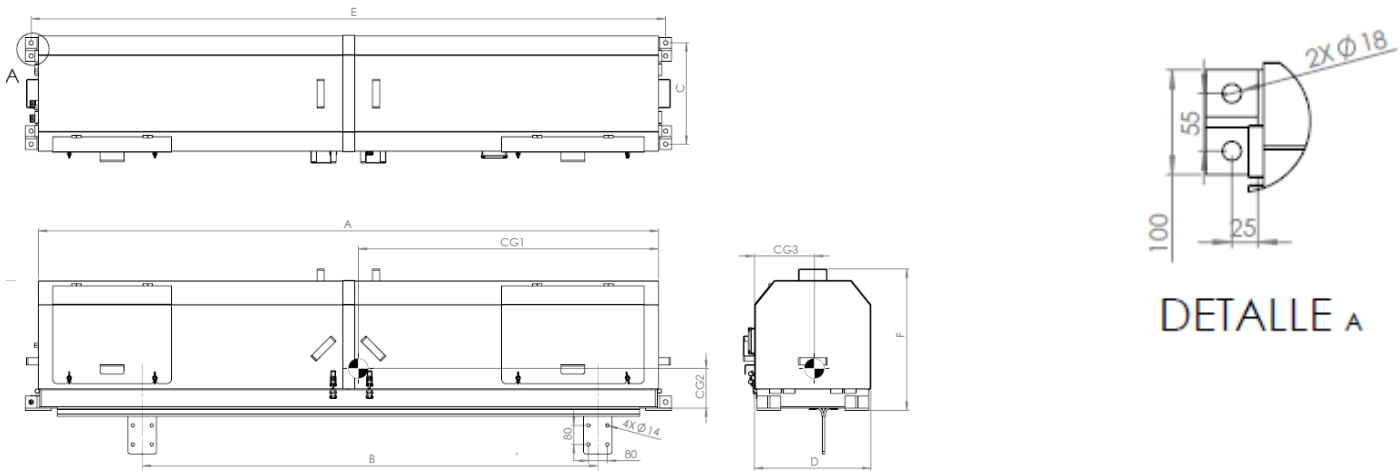

width Inch	Transmission sizes table														
	A	B	C	D	E	F	G	CG1	CG2	CG3	Wt (Kg)		Vol. m3		Power kW
												SC-201-A	SC-201-PA	SC-201-A	SC-201-PA
4	1676	994	425	490	1736	425	188	762	194	243	285		0,37		0,75
6	1730	1168			1790			799	182		291		0,39		
8	1782	1220			1842			823	181		297		0,40		
10	1835	1273			1895			848	180		303		0,41		
12	1885	1323			1945			872	180		309		0,42		
14	1918	1356			1978			888	180		312		0,42		
16	2102	1410			2162			972	177		336		0,46	1,1	
18	2152	1460			2212			992	177		341		0,47		
20	2202	1510			2262			1020	176		346		0,48	1,5	
24	2302	1610			2362			1067	177		356	500	0,50		0,90
26	2352	1660			2412			1090	175		361		0,51		
30	2442	1750			2502			1133	174		371	530	0,53		0,95
36	2607	1915			2667			1212	173		388		0,57	1,02	2,2
40	2707	2015			2767			1260	172		399		0,59		
42	2762	2071			2822			1283	172		404	560	0,60	1,08	3
48	2912	2220			2972			1359	171		422	590	0,63	1,13	
54	3207	2425	740	676	3267	515		170	323		620		1,25		
60	3437	2655			3497			170			650		1,33		
72	3732	2950			3792			170			680		1,45		

**Note:**

1. RDI S.A. reserves the right to modify models, components, specifications and models continuity at any momento, at any time without previous notification.

